

ТРЪБИ ЗА КАНАЛИЗАЦИЯ PIPES FOR SEWERAGE SYSTEMS

ТРЪБИ ДВУСЛОЙНИ

(с гладка вътрешна и гофрирана външна стена)

DOUBLE WALL PIPES

(with smooth inner wall and corrugated outer wall)

БТО 047/2006 г.

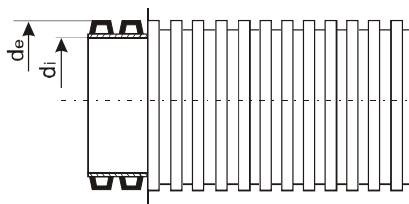
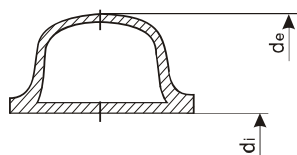

Ном. No Nom. No	d, mm	d, mm	Тегло Weight kg/m
SN 4 kN/m²			
4921500111	150	170,0	1,150
4922000111	200	226,5	1,850
4923000111	300	340,0	3,900
4924000111	400	453,0	7,600
SN 8 kN/m²			
4921500121	150	170,0	1,375
4922000121	200	226,5	2,320
4923000121	300	340,0	5,900
4924000121	400	453,0	9,500



ТРЪБИ ДВУСЛОЙНИ ПЕРФОРИРАНИ DOUBLE WALL PERFORATED PIPES

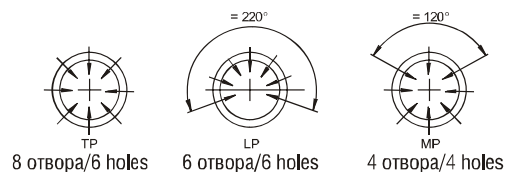

Ном. No Nom. No	d, mm	d, mm	Тегло Weight kg/m	Брой и обща повърхност на отворите Number and total surface of holes					
				TP		LP		MP	
				бр./м	cm ² /m	бр./м	cm ² /m	бр./м	cm ² /m
SN 4 kN/m²									
4921500211	150	170,0	1,150	432	≤ 180	324	≤ 140	216	≤ 90
4922000211	200	226,5	1,850	384	≤ 160	288	≤ 120	192	≤ 80
4923000211	300	340,0	3,900	240	≤ 100	180	≤ 75	120	≤ 50
SN 8 kN/m²									
4921500221	150	170,0	1,375	432	≤ 180	324	≤ 140	216	≤ 90
4922000221	200	226,5	2,320	384	≤ 160	288	≤ 120	192	≤ 80
4923000221	300	340,0	5,900	240	≤ 100	180	≤ 75	120	≤ 50



СВЪРЗВАЩИ ЧАСТИ ЗА КАНАЛИЗАЦИЯ FITTINGS FOR SEWERAGE SYSTEMS

ДВОЙНИ НЕПРОХОДНИ МУФИ DOUBLE NON-PASSING SOCKETS

БТО 047/2006 г.

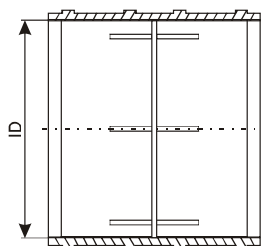

Ном. No Nom. No	Номинален размер Nominal size DN/ID	ID mm	Тегло, kg/бр. Weight, kg/m	Брой в един палет Number in one pallet	
				1200/800	1300/1100
50260012	150	178	0,615	144	252
50260022	200	235	0,815	90	120
50260032	300	348	2,100	24	36
50260042	400	460	4,800	-	12

